

AQUA PUMP

Ⓞ GB HY-AQUARIUMS PUMP
OPERATION MANUAL

PROFESSIONAL

Ⓞ D HY-SERIE PUMPE
BEDIENUNGSANLEITUNG

Ⓞ JP HY-シリーズ
使用説明書

Ⓞ 中文 HY-系列水泵
使用说明书

- Copper wire motor
- Noise reduction design
- Ceramic shaft center
- German Industry Standard

- Kupferdraht-Motor
- Keramik-Achse
- Geräuschreduzierung Design
- Deutscher Industriestandard

- 銅線モーター
- 騒音ダウン設計
- 陶瓷軸心
- ン設計 ドイツ工業標準

- 铜线电机
- 降噪设计
- 陶瓷轴心
- 德国工业标准



User Manual

Thank you for choosing the product. Please carefully read this instruction and operate the product strictly according to this instruction before you use this product.

Description

This product is made from high-quality materials with beautiful and simple features and easy operation. It is designed for fish tanks and aquarium, gardens and products and places with circulating water function, such as air conditioner fan, air-cooler, planting plate, filter, fountain technology and other purposes.

Product features

1. High-quality plastic shell, beautiful and simple
2. Functioning drawing water, circulation and filtration, oxygenation and water supply.

Attentions

1. The power plug is not waterproof. Please keep it away from water and water vapor.
2. Working voltage and frequency must be compatible with specified voltage frequency of water pump.
3. Do not touch the power plug with wet hands. The power supply is turned off before the submersible pump is cleaned and maintained, and taken out.
4. The submersible pump is for water use only; please avoid using in corrosive liquid.
5. When this product does not work properly, this product shall be repaired by professional personnel. The product must be used for underwater diving. This product is not a toy, please stay away from children.

Model	Power	Pump capacity	Pump head	Accessories	water nozzle	Size (cm)
HY-302	6W	500L/H	0.8m	Boost oxygen hose	13mm+boost oxygen water nozzle	7.2x4.5x7.8
HY-303	8W	800L/H	1m	Boost oxygen hose	13mm+boost oxygen water nozzle	7.2x4.5x7.8
HY-312	12W	1200L/H	1.2m	Boost oxygen hose	13\16mm+boost oxygen water nozzle	10x5.6x9.6
HY-313	15W	1500L/H	1.6m	Boost oxygen hose	13\16mm+boost oxygen water nozzle	10x5.6x9.6
HY-500F	6W	500L/H	0.8m	1 section filter tank + boost oxygen tube	13mm+boost oxygen water nozzle	13x4.3x5.6
HY-800F	8W	800L/H	1m	2 sections filter tank + boost oxygen tube	13mm+boost oxygen water nozzle	13x4.3x5.6
HY-1200F	12W	1200L/H	1.2m	2 sections filter tank + boost oxygen tube	13\16mm+boost oxygen water nozzle	23.5x5.6x6.8
HY-1500F	15W	1500L/H	1.6m	2 sections filter tank + boost oxygen tube	13\16mm+boost oxygen water nozzle	23.5x5.6x6.8

Input voltage: AC 110-120V 50/60HZ AC 220-240V 50/60HZ

All pumps must be used for underwater diving

Specific model parameters refer to water pump label

Product description



Schematic view of the product

HY-302/303/312/313

- | | |
|--------------------|---------------------------|
| 1. Water pump host | 7. Seal ring |
| 2. Motor | 8. Water flow switch |
| 3. Rear cover | 9. Middle cover |
| 4. Cable clamp | 10. Filter tank |
| 5. Sucker | 11. Effluent water nozzle |
| 6. Rotor | |

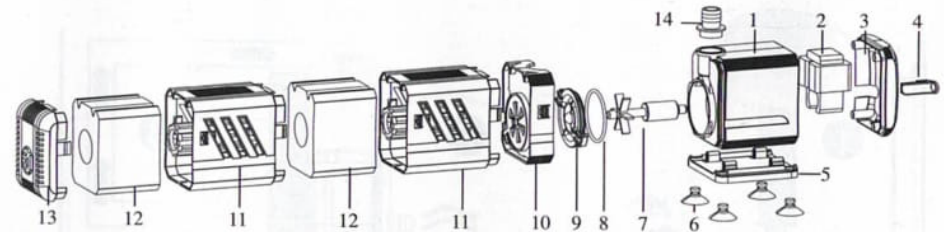
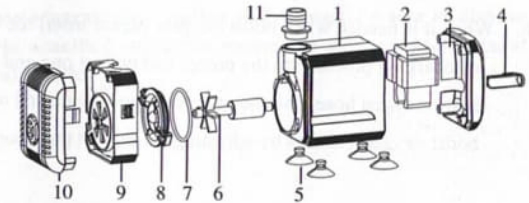

HY-500F/800F/1200F/1500F

- | | | |
|-----------------------|----------------------|---------------------------|
| 1. Water pump host | 6. Sucker | 11. Filter tank |
| 2. Motor | 7. Rotor | 12. Cotton filter |
| 3. Rear cover | 8. Seal ring | 13. Influent cover |
| 4. Cable clamp | 9. Water flow switch | 14. Effluent water nozzle |
| 5. Suction disc plane | 10. Middle cover | |

HY-302/303/312/313 Water Pump

HY-500F/800F/1200F/1500F with filtration and boost oxygen water pump

Operating instructions

1. Open the package and then take out pump. Check whether the pump is damaged or the power line is broken. The maximum submersible depth of submersible pump is 1m
2. Insert the plug of filter into the power socket higher than water level and with leakage switch, choose appropriate discharging tube and water nozzle of accessories, connect them and fix submersible pump with a sucking disc, and turn on the power, then it works. For the initial use, please carry out submersible work!
3. After the pump works for a period of time, there are some impurities, causing increased noise and blocked pump and water inlet. Please timely clean the impurities in the submersible pump!
4. Cleaning and maintenance of submersible pump: Separate grille of submersible pumps and water leaves, and take out rotor, ceramic shaft and water leaves inside it, and put pump head and accessories into clear water, and clean its surface with a brush, and regularly clean and replace cotton filter. Install and assemble it after cleaning as per the instruction.
5. When different water-yields are needed, adjust flow switch +/- on the pump to control it.
6. When it is needed when boost oxygen, please insert the boost oxygen water nozzle into the discharging position on the pump, and collect one end of boost oxygen hose to air water nozzle of boost oxygen hose, and the other end must be placed outside of water tank, and control size of boost oxygen bubbles by adjusting air flow at the hose end.

1. Fountain technology 2. Filtration of fish tank 3. Garden technology

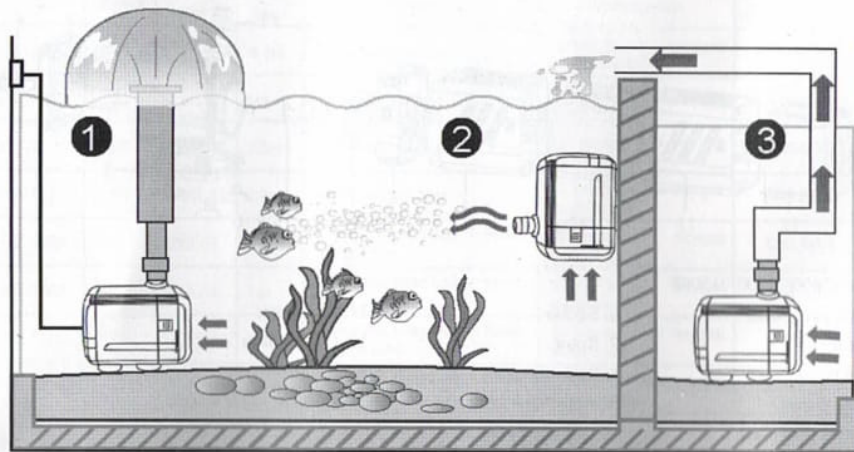

Solutions common problems of pump:

1. The pump of loud noise: A lack of water. Fully submersible to realize the noise reduction.
2. Reduction of water yield: There are impurities blocked in the water inlet! A water inlet of pump is not submersible fully, and water pipe equipped to the water outlet is larger than the pipe diameter of water outlet or switch of water flow is not adjusted to the maximum
3. Reduction of the pump head: Water pipe equipped to the water outlet is larger than the pipe diameter of water outlet.
4. The pump shut down: When the pump runs difficultly upon startup, the magnetic rotor of pump may be demagnetized, so the rotor shall be timely replaced or the pump shall be far away from the large magnetic field for operation.
5. Difference of flow: Because voltage and frequency and discharging tube is not consistent, deviation of flow will happen. The flow value shown in the model is the standard reference value.

※※※ To our dear customers- Being made from high-quality materials and components, the product can be recycled and reused. Please separate the product and domestic waste to dispose when its service life expires, and send it to a unified collection station for protection of natural resources, human health and environmental health.