

# Technical Data Sheet

CODE 17172

## LINEO 150 QUIET ES

Sound-proof energy saving mixed flow  
extractor fans



### Certifications



CB TEST CERTIFICATE

## Technical and performance data

Corrente max assorbita a 2V (A)	0,09	Max pressure at 6V (Pa)	73,6
Frequency (Hz)	50-60	Max pressure at 10V (mmH2O)	24,2
Insulation class	II°	Max pressure at 4V (mmH2O)	4,6
IP	45	Max pressure at 6V (mmH2O)	7,5
Max absorbed current at 10V (A)	0,34	Max pressure at 8V (mmH2O)	14,7
Max absorbed current at 4V (A)	0,11	Max pressure at 8V (Pa)	144,2
Max absorbed current at 6V (A)	0,14	Portata max a 2V (l/s)	33,3
Max absorbed current at 8V (A)	0,24	Portata max a 2V (m3/h)	120
Max absorbed power at 10V (W)	31	Potenza sonora Lw [dB (A)] IN	46,5
Max absorbed power at 4V (W)	7,7	ASPIRAZIONE - a 2V	
Max absorbed power at 6V (W)	10,6	Potenza sonora Lw [dB (A)] IN MANDATA	45,5
Max absorbed power at 8V (W)	20	- a 2V	
Max ambient temperature for continuous operation (°C)	60	Pressione max a 2V (mmH2O)	1
Nominal diameter (mm)	150	Pressione max a 2V (Pa)	9,8
Potenza max assorbita a 2V (W)	4,2	Pressione sonora Lp [dB (A)] 3m IN	29
Voltage (V)	220-240	ASPIRAZIONE - a 2V	
Weight (Kg)	5,4	Pressione sonora Lp [dB (A)] 3m IN	28
Breakout sound power at 10V Lw [dB (A)]	51,5	MANDATA - a 2V	
Breakout sound power at 2V LWA [dB (A)]	28,5	Pressione sonora Lp [dB (A)] 3m	8
Breakout sound power at 4V Lw [dB (A)]	34,2	IRRADIATO - a 2V	
Breakout sound power at 6V Lw [dB (A)]	39,1	RPM 2V	505
Breakout sound power at 8V Lw [dB (A)]	46,5	RPM at 10V	2030
Breakout sound pressure at 3m at 10V Lp [dB (A)]	31	RPM at 4V	1015
Breakout sound pressure at 3m at 4V Lp [dB (A)]	13,7	RPM at 6V	1240
Breakout sound pressure at 3m at 6V Lp [dB (A)]	18,6	RPM at 8V	1700
Breakout sound pressure at 3m at 8V Lp [dB (A)]	26	Sound power at extract side at 10V speed LWA [dB (A)]	58,2
Max airflow at 10V (l/s)	143,1	Sound power at extract side at 4V speed LWA [dB (A)]	40
Max airflow at 10V (m³/h)	515	Sound power at extract side at 6V speed LWA [dB (A)]	44,7
Max airflow at 4V (l/s)	69,4	Sound power at extract side at 8V speed LWA [dB (A)]	53,2
Max airflow at 4V (m³/h)	250	Sound power at supply side at 10V speed LWA [dB (A)]	58,2
Max airflow at 6V (l/s)	84,7	Sound power at supply side at 4V speed LWA [dB (A)]	40,9
Max airflow at 6V (m³/h)	305	Sound power at supply side at 6V speed LWA [dB (A)]	45,9
Max airflow at 8V (l/s)	119,4	Sound power at supply side at 8V speed LWA [dB (A)]	53,8
Max airflow at 8V (m³/h)	430	Sound pressure at extract side at 3m at 10V Lp [dB (A)]	40,7
Max pressure at 10V (Pa)	237,3	Sound pressure at extract side at 3m at 4V Lp [dB (A)]	22,5
Max pressure at 4V (Pa)	45,1	Sound pressure at extract side at 3m at 6V Lp [dB (A)]	27,2
		Sound pressure at extract side at 3m at 8V Lp [dB (A)]	35,7
		Sound pressure at supply side at 3m at 10V Lp [dB (A)]	40,7
		Sound pressure at supply side at 3m at 4V Lp [dB (A)]	23,4
		Sound pressure at supply side at 3m at 6V	28,4

Lp [dB (A)]	
Sound pressure at suply side at 3m at 8V	36,3
Lp [dB (A)]	

## Dimensions

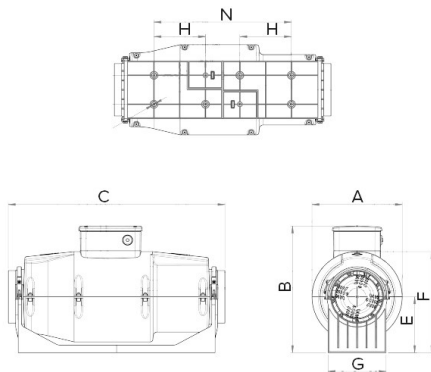

Size A (mm)	232
Size B (mm)	320,6
Size C (mm)	685
Size D (mm)	Ø 147
Size E (mm)	145
Size F (mm)	261,5
Size G (mm)	170
Size H (mm)	132
Size L (mm)	85
Size M (mm)	Ø 5,5
Size N (mm)	360

### PER INFORMAZIONI / FOR INFORMATION

#### ITALY

Pre Sales:

[prevendita@vortice-italy.com](mailto:prevendita@vortice-italy.com)

After Sales:

[postvendita@vortice-italy.com](mailto:postvendita@vortice-italy.com)

#### UNITED KINGDOM & REP. OF

##### IRELAND

Sales Dept:

[sales@vortice.ltd.uk](mailto:sales@vortice.ltd.uk)

Technical Dept:

[technical@vortice.ltd.uk](mailto:technical@vortice.ltd.uk)

#### OTHER COUNTRIES

Sales Dept:

[export@vortice-italy.com](mailto:export@vortice-italy.com)

After Sales:

[after-sales@vortice-italy.com](mailto:after-sales@vortice-italy.com)

# Technical Data Sheet

CODE 17172

## LINEO 150 QUIET ES

Sound-proof energy saving mixed flow  
extractor fans



## Description

- Enclosures made of fire resistant plastic resin, E2 class, according with ISO EN 11925-2: 2010, in areas close to motor and electrical components.
- Casing integrating a sound-absorbing coating, optimized to minimize sound emissions radiated into the environment and transmitted through exhaust and supply ducts.
- Nominal diameter 150 mm.
- EC (brushless) motor, thermally protected, with shaft mounted on ball bearing supports, coupled with a centrifugal impeller.
- High water resistance: IPX5 (if installed in a duct).
- Equipped with a thermal fuse overheating safety device.
- Speed adjustable through potentiometer (0-10V signal) or two-speed switch (to be set at the installation in a preset range).

## Curves

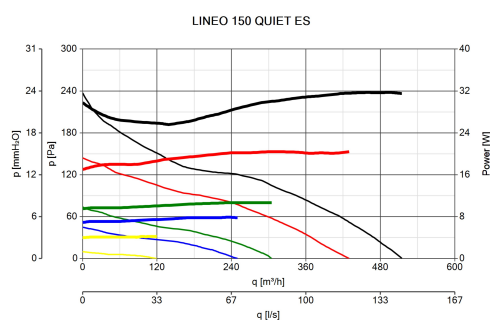

## Accessories



### C TEMP

Code 12992



### C SMOKE

Code 12993



### C HCS

Code 12994



### C PIR

Code 12998

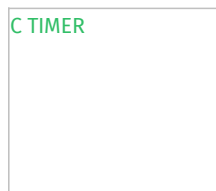

### C TIMER

Code 12999



### POT-IT

Code 12826



### POT

Code 12828

PER INFORMAZIONI / FOR INFORMATION

ITALY

Pre Sales:  
prevendita@vortice-italy.com

UNITED KINGDOM & REP. OF

IRELAND  
Sales Dept:  
sales@vortice.ltd.uk

OTHER COUNTRIES

Sales Dept:  
export@vortice-italy.com

After Sales:  
postvendita@vortice-italy.com

Technical Dept:  
technical@vortice.ltd.uk

After Sales:  
after-sales@vortice-italy.com