

GLOBAL AIR SUPPLIES UK EC 2 CONTROLLER

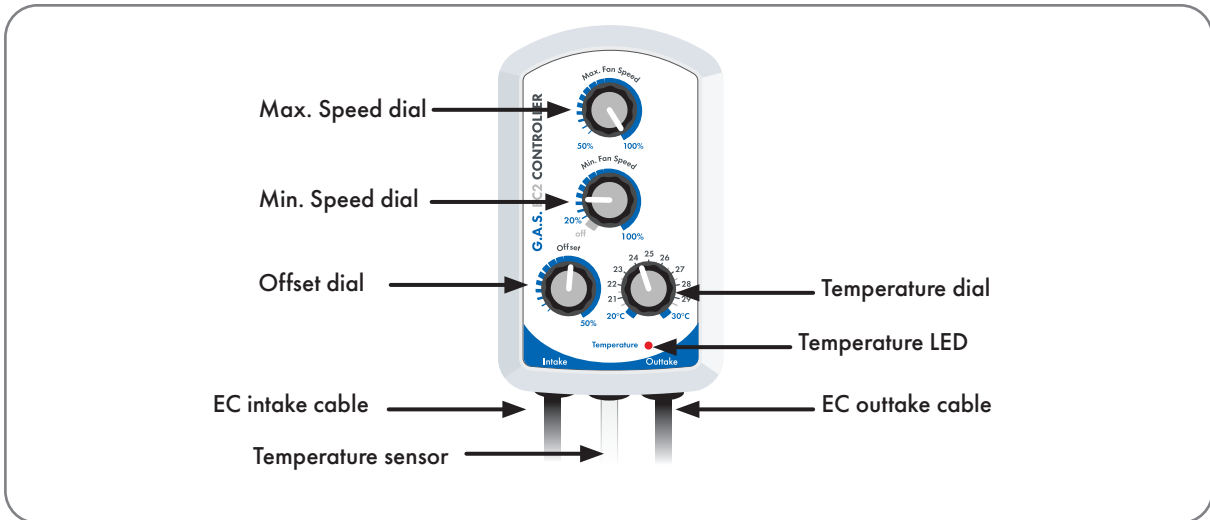

STEP 1 CONNECTING TO YOUR FANS USING ACTIVE CABLES

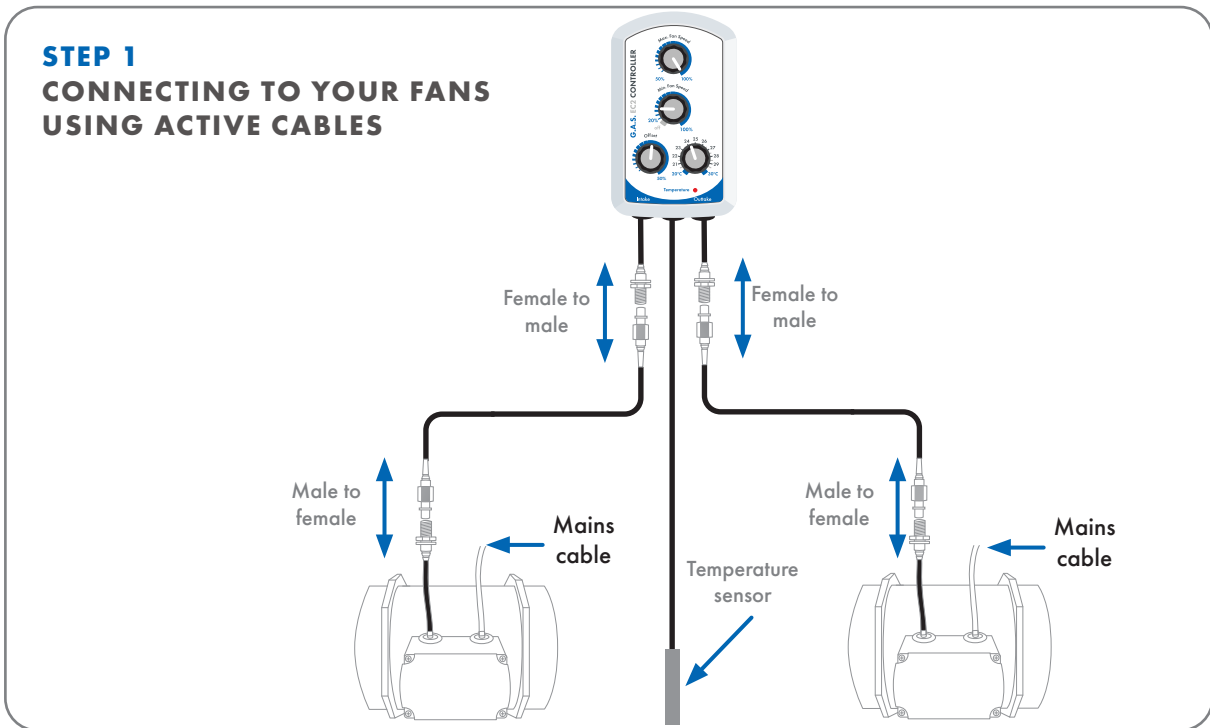

STEP 2 SETTING TEMPERATURE

Turn the temperature dial to set the temperature. The controller will maintain the minimum fan speed until the set temperature is reached, it will then gradually increase the fan speed as required. The fans will run at maximum speed if the temperature reaches 2°C above the set temperature.

The temperature LED will be on when above set temperature.

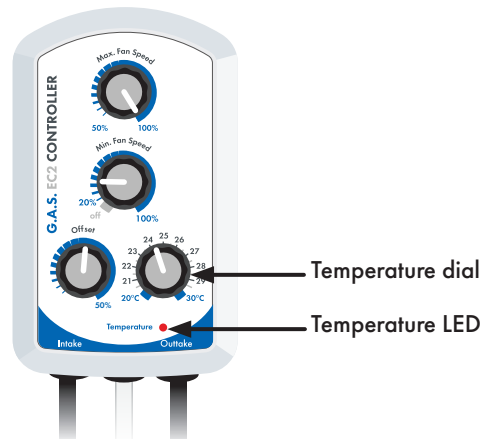

STEP 3

SETTING UP MAXIMUM & MINIMUM FAN SPEED

Turn the Max. Speed dial to set the maximum fan speed. This can be set between 50% and 100% speed.

Turn the Min. Speed dial to set the minimum fan speed. This can be set between off and 100% speed.

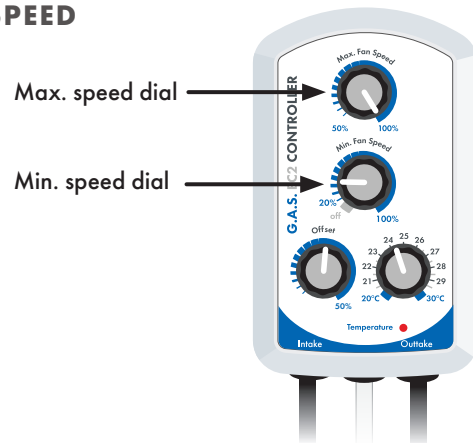

STEP 4

SETTING UP FAN OFFSET

The fan offset is the percentage reduction in speed in the intake fan compared to the outtake fan. This is used to create negative pressure.

The offset can be 0% to 50%.

If set at 20% the intake fan will run 20% slower than the outtake fan.

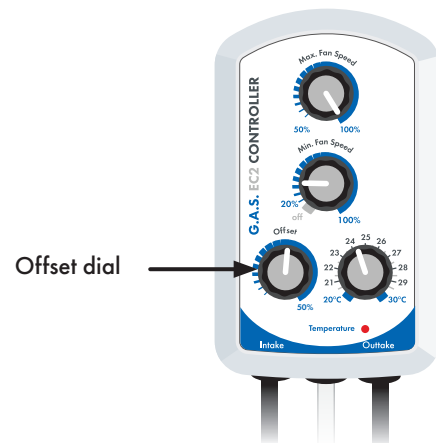

TEMPERATURE SENSOR

POSITION IN THE CENTRE OF YOUR ROOM

The temperature sensor will work best in the centre of your room. You should ensure there is ventilation of the air to prevent hot spots, such as a DiffuseAir or oscillating fans.

Shading the probe from direct light will give best results.

